

Gli elettropiloti a comando diretto sono particolarmente indicati per montaggio su basi multiple oppure su basi singole, permettono un basso assorbimento di energia ed hanno un piccolo comando monostabile per intervento manuale.

The solenoid valves directly controlled are suitable for assembling on multiple or single bases; they have a low consumption of energy and have a small monostable control for an eventual manual intervention.

DATI TECNICI / TECHNICAL DATA

Tipo / Type	3/2 NC
Pressione massima di esercizio / Max operating pressure	10 bar
Temperatura max di esercizio / Max working temperature	+50 C°
Portata / flow rate	30 NI/min
Diametro nominale / Nominal orifice	1,1mm
Durata cicli / Life time	100 millions cycles
Tolleranza di tensione / Tension tolerance	-10% - +15%
Tempo di risposta / Response time	10ms
Inserimento / duty cycle	ED 100%
Consumo a regime / rated power consumption	DC: 2W - AC: 1.3VA
Protezione / protection	IP 51

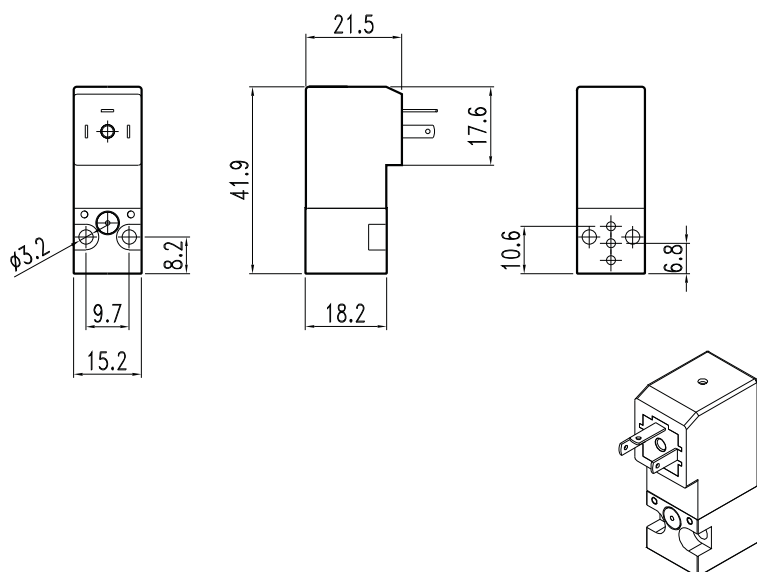

CODE	DES.
EP3112	3/2 NC 12V DC
EP3122	3/2 NC 24V DC
EP3132	3/2 NC 24V AC
EP3142	3/2 NC 110V AC
EP3152	3/2 NC 220V AC

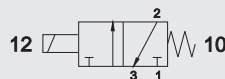

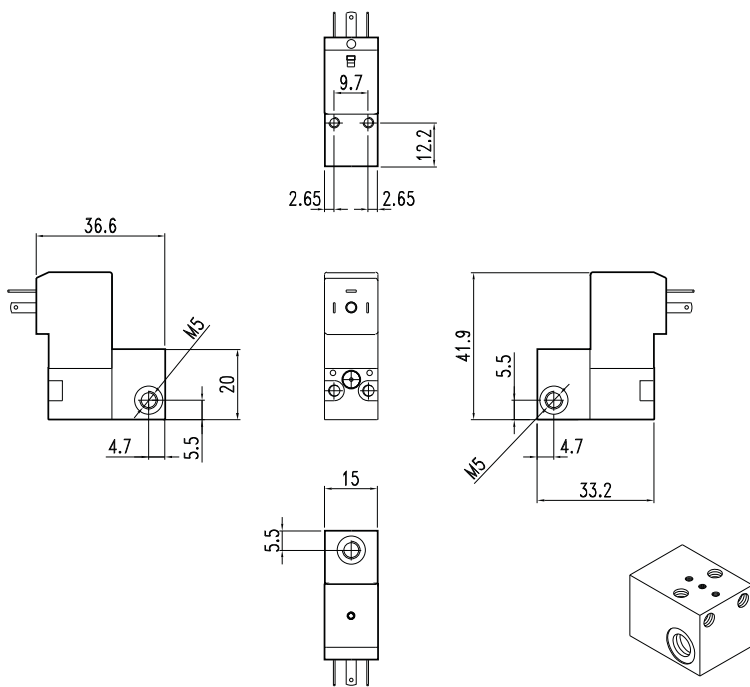

BASE SINGOLA
SINGLE MANIFOLD

CODE _____
SB402101 _____

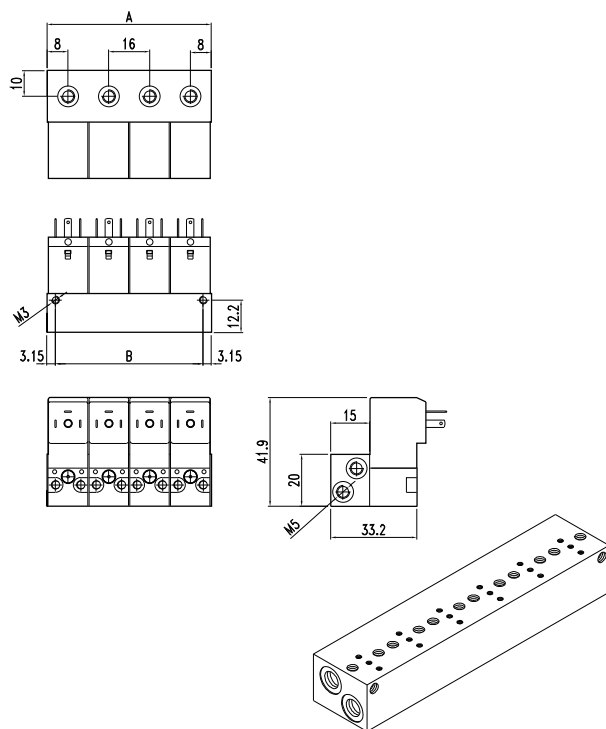

BASE MULTIPLA
MANIFOLD

CODE	POS.	A	B
SB402102	2	32	25.7
SB402103	3	48	41.7
SB402104	4	64	57.7
SB402105	5	80	73.7
SB402106	6	96	89.7
SB402107	7	112	105.7
SB402108	8	128	121.7
SB402109	9	144	137.7
SB402110	10	160	153.7

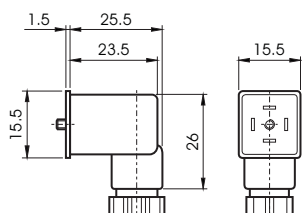

CONNETTORI
CONNECTORS

CODE	DES.
VX0020	STANDARD
VX0021	LED 24V
VX0022	LED 110V
VX0023	LED 220V
VX0024	LED VDR 24V
VX0025	LED VDR 110V
VX0026	LED VDR 220V